

QS	Power switch	SB2	Downside button
QF	Circuit interrupter	SB3	Tooth lock button
QF1	Circuit interrupter	KM	A.C. contactor
TC	Transformer	KA	intermediate relay
VC	rectifier bridge	KT	Time relay
HL	Indicator	QV	Three-way magnetic valve (Pneumatic)
SB1	Upside button	YV	electromagnetic unloading valve (Hydraulic)

Refer to the above circuit diagram for the connection of the motor.
The rotation of the motor should be towards the direction of the pump, if not, amend the connection of motor.

13. STRUCTURE DIAGRAM

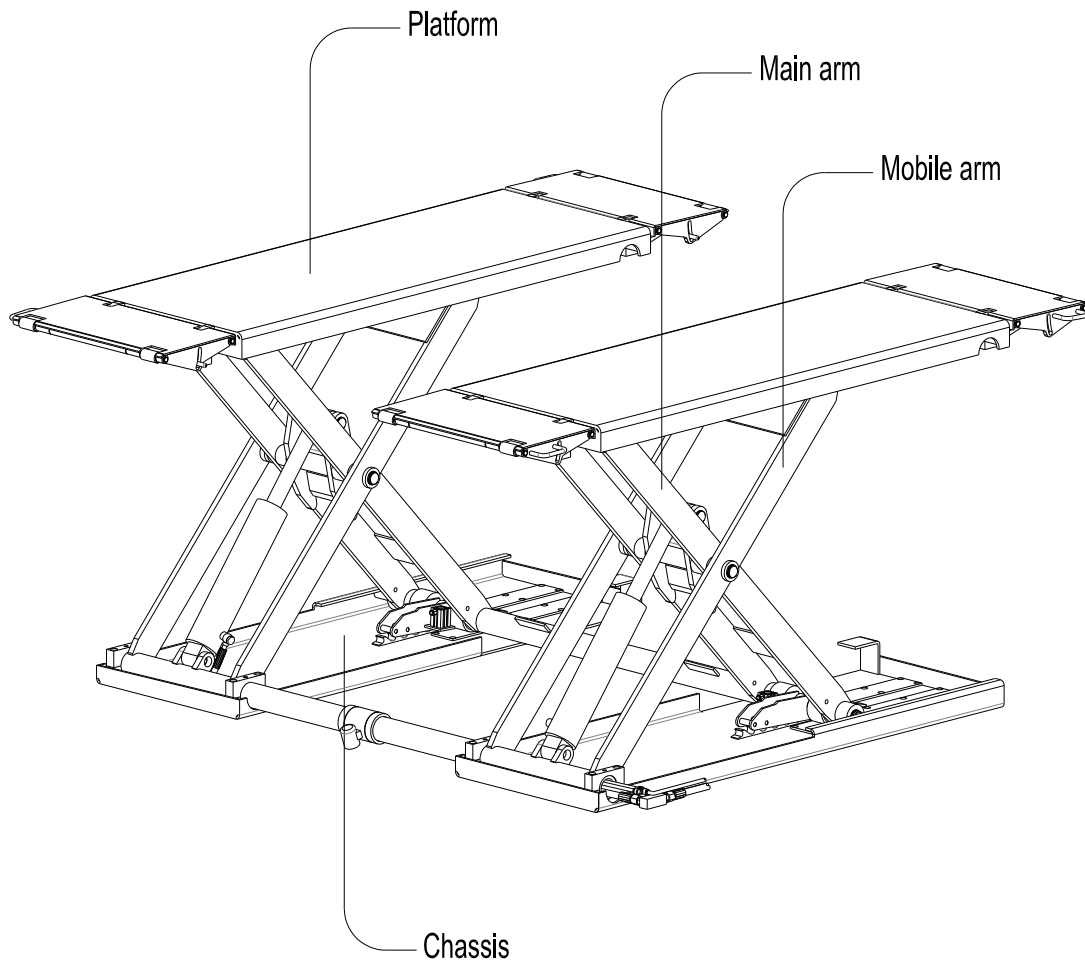

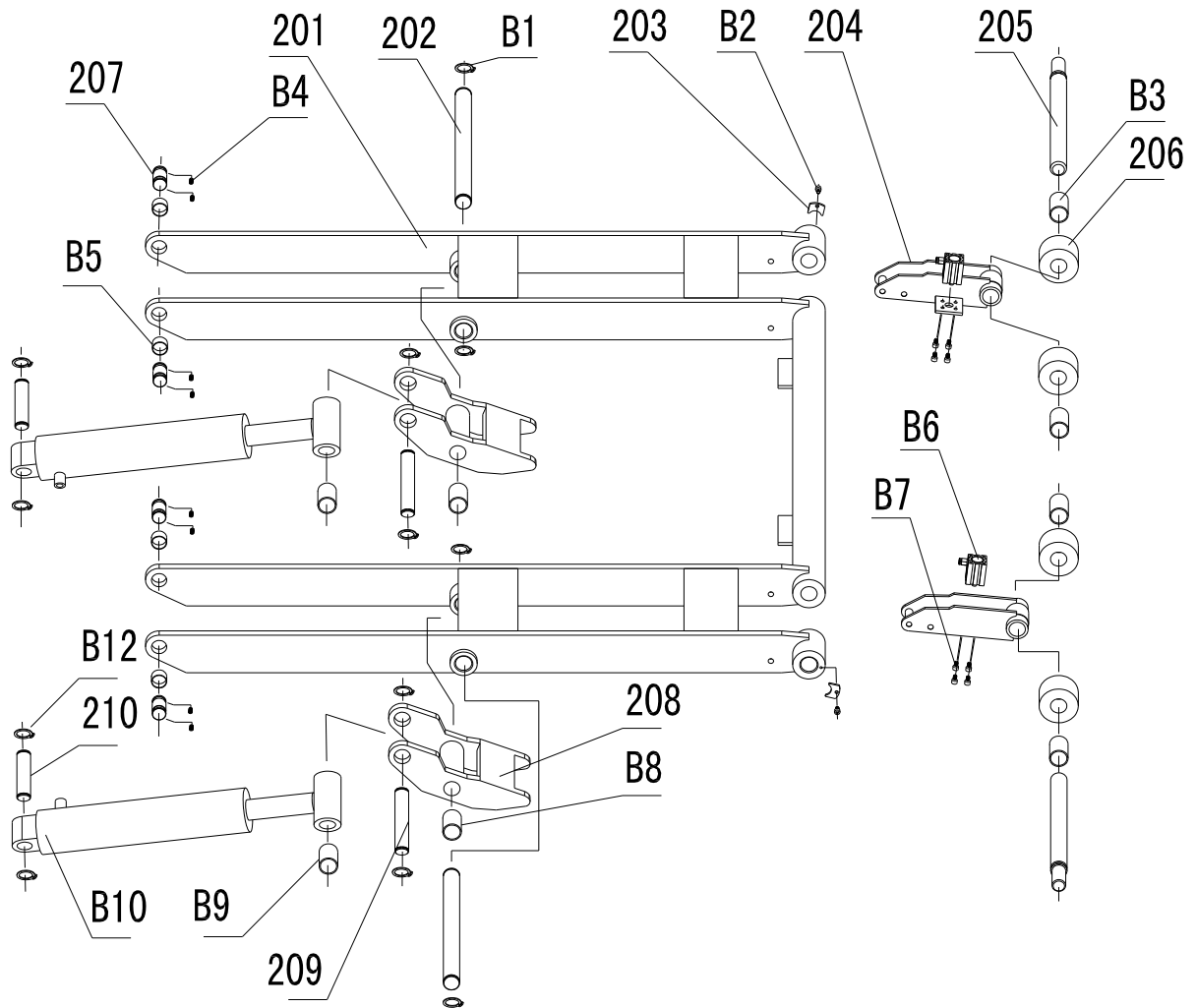
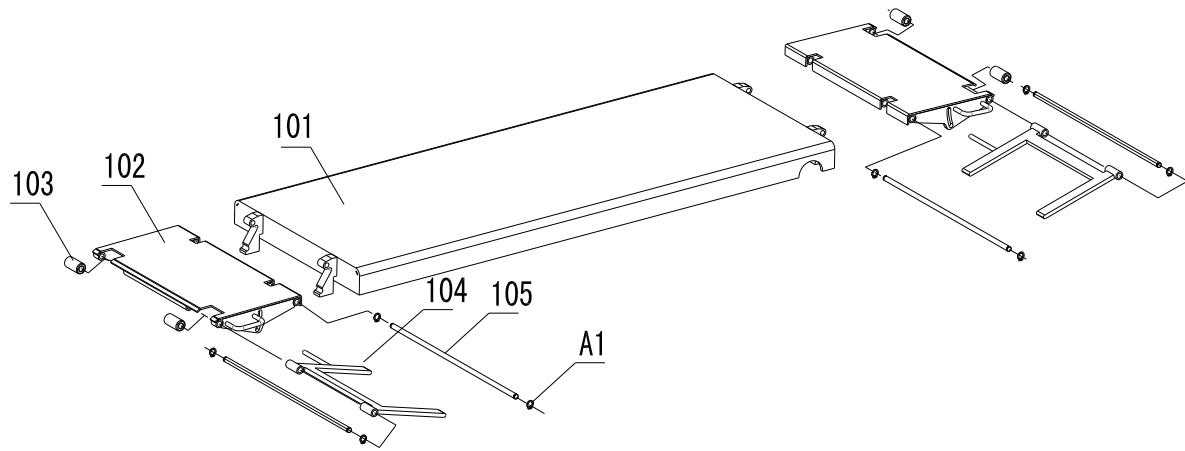

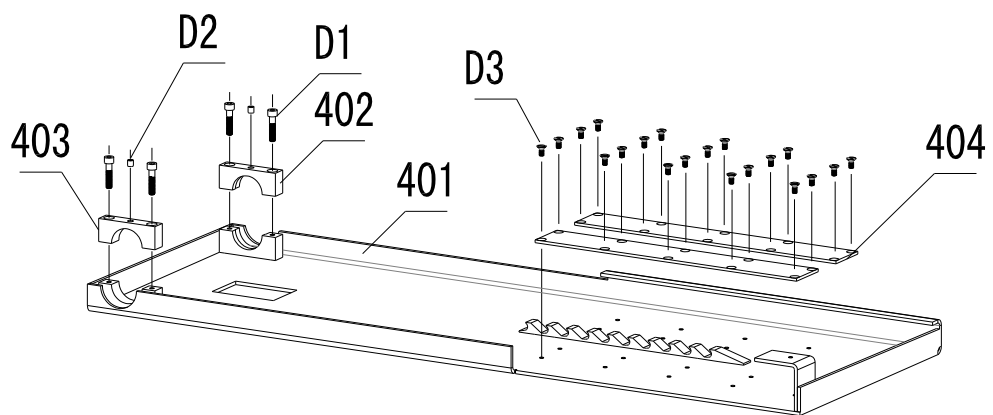
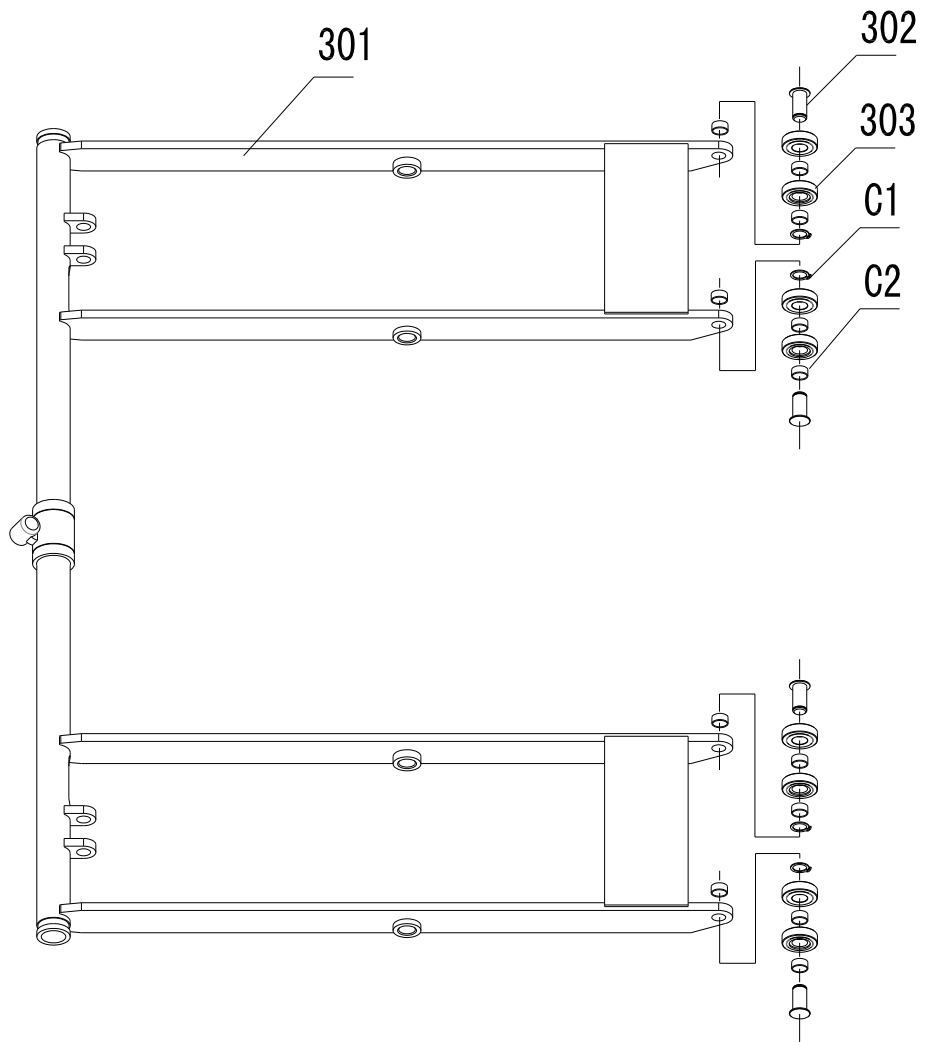

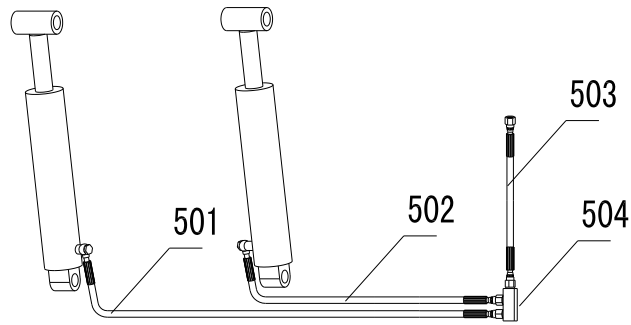

Code	Name	Code	Name
101	Platform assembly	B6	Cylinder
102	Front plate	B7	M5×25 inner hexagonal bolt
103	Front plate trolley	B8	3030 oilless bearing
104	Support for front plate	B9	2530 oilless bearing
105	Fasten axle for front plate	B10	cylinder
A1	Φ 12 circlip	301	Outside scissor frame
201	Inside scissor frame assembly	302	Trolley for outside scissor
202	Middle axle of scissor	303	Trolley axle for outside scissor
203	Fasten plate for trolley axle of inside scissor	C1	2515oilless bearing
204	Lock hook	C2	Φ 25 circlip
205	Trolley axle for inside scissor	401	Bed plate assembly
206	Trolley for outside scissor	402	Fasten base on the outside of Outside scissor
207	Fasten axle for inside scissor	403	Fasten base on the inside of Outside scissor
208	Assistant arm	404	Trolley base plate for inside scissor
209	Top-shaft for cylinder	D1	M10 × 55 inner hexagonal bolt
210	bottom-shaft for cylinder	D2	Φ 10 grease cup
B1	Φ 30 circlip	D3	M8×12 sunk screw
B2	M6 × 12 inner hexagonal bolt	501	pipeline for long cylinder
B3	3050 oilless bearing	502	Pipeline for short cylinder
B4	M6 × 12 inner hexagonal locking bolt	503	pipeline for Pump station
B5	2515 oilless bearing		